

**Fig. FH**



**Class 125**

FH... Threaded ends to BS21

**Screwed bonnet, Non-rising stem, Solid wedge disc, Integral seats, Threaded ends to BS21 or NPT, or solder joint ends.\***

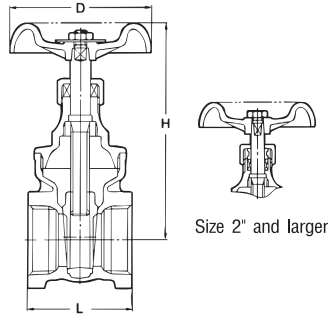

Size 2" and larger

**★ Caution**

Solder joint end valves should not be used in service where the temperature of the line fluid is higher than the softening point of solder.

**1.38 MPa (200 psi) W.O.G. non-shock  
0.86 MPa (125 psi) S.P. saturated**

**Materials**

Parts	Material
Body	Brass
Bonnet	Brass
Stem	K-Metal <sup>☆</sup>
Disc	Brass
Packing nut	Brass
Gland*	Brass rod
Gland packing	Aramid fiber PTFE
Lock nut	Brass rod
Handwheel	Die-cast zinc (1 <sup>1</sup> / <sub>4</sub> "~1 <sup>1</sup> / <sub>4</sub> ") Die-cast aluminum (1 <sup>1</sup> / <sub>2</sub> "~3")

<sup>☆</sup> K-Metal is a special brass developed for anti-dezincification.

<sup>\*</sup> Size 2" and larger.

**Dimensions**

Valve size		inch	1/4	3/8	1/2	3/4	1	1 1/4	1 1/2	2	2 1/2	3
		mm	8	10	15	20	25	32	40	50	65	80
L	Threaded end to end		35	38	42	47	50	60	63	72	82	92
L <sub>1</sub>	Solder end to end		-	37	45	60	70	77	86	104	115	127
H	Height (FH/AKFH)		70	73	73	87	97	118	126	154	187	205
D	Handwheel diam.		50	50	50	55	60	70	80	90	100	115
G			-	9.7	12.7	19.1	23.1	24.6	27.7	34.0	37.4	42.2

**Test pressure:**

Shell 2.07 MPa (300 psi) (Hydrostatic)  
Seat 1.38 MPa (200 psi) (Hydrostatic)  
Seat 0.55 MPa (80 psi) (Air)

**Fig. H**



**Class 125**

H... Threaded ends to BS21

**Inside screw, Non-rising stem, Screwed-over-Bonnet,\* Solid wedge disc, Threaded ends to BS21 or NPT, or solder joint ends.\***

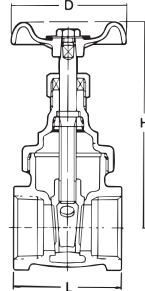

\* Screwed bonnet for 2 1/2" & larger sizes

**★ Caution**

Solder joint end valves should not be used in service where the temperature of the line fluid is higher than the softening point of solder.

**1.38 MPa (200 psi) W.O.G. non-shock  
0.86 MPa (125 psi) S.P. saturated**

**Materials**

Parts	Material
Body	Bronze
Bonnet	Bronze
Stem	K-Metal <sup>☆</sup>
Disc	Bronze / K-Metal <sup>☆*</sup>
Lock nut	Brass rod
Packing nut	Brass
Gland**	Brass rod
Gland packing	Aramid fiber PTFE
Handwheel	Die-cast zinc (3/8"~1 1/4") Die-cast aluminum (1 1/2"~4")

<sup>☆</sup> K-Metal is a special brass developed for anti-dezincification.

<sup>\*</sup> 3/8" and 1/2" for H.

<sup>\*\*</sup> Size 1 1/2" and larger.

**Dimensions**

Valve size		inch	3/8	1/2	3/4	1	1 1/4	1 1/2	2	2 1/2	3	4
		mm	10	15	20	25	32	40	50	65	80	100
L	Threaded end to end		42	45	50	57	61	67	74	90	100	121
L <sub>1</sub>	Solder end to end		39	46	61	72	78	87	102	115	130	173
H	Height		74	80	90	105	118	135	159	202	223	280
D	Handwheel diam.		50	50	55	60	70	80	90	115	135	155
G			9.7	12.7	19.1	23.1	24.6	27.7	34	37.4	42.2	54.9

**Test pressure:**

Shell 2.07 MPa (300 psi) (Hydrostatic)  
Seat 1.38 MPa (200 psi) (Hydrostatic)  
Seat 0.55 MPa (80 psi) (Air)

**Fig. E**



**Class 150**

**Inside screw, Non-rising stem, Screwed Bonnet, Solid wedge disc, Threaded ends to BS21.**

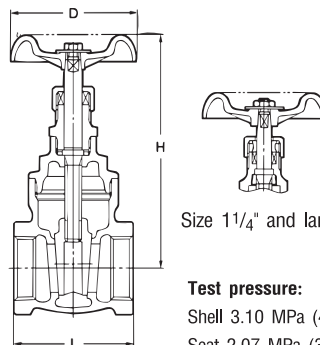

Size 1 1/4" and larger

**Test pressure:**

Shell 3.10 MPa (450 psi) (Hydrostatic)  
Seat 2.07 MPa (300 psi) (Hydrostatic)

**2.07 MPa (300 psi) W.O.G. non-shock  
1.03 MPa (150 psi) S.P. saturated**

**Materials**

Parts	Material
Body	Bronze
Bonnet	Brass / bronze*
Stem	K-Metal <sup>☆</sup>
Disc	Bronze
Packing nut	Brass
Gland**	Brass rod
Gland packing	Aramid fiber PTFE
Stuffing box	Brass rod / brass
Handwheel	Die-cast zinc (3/8"~1") Die-cast aluminum (1 1/4"~3")

<sup>☆</sup> K-Metal is a special brass developed for anti-dezincification.

<sup>\*</sup> Bronze for 2 1/2" and larger.

<sup>\*\*</sup> Size 1 1/4" and larger.

**Dimensions**

Valve size		inch	3/8	1/2	3/4	1	1 1/4	1 1/2	2	2 1/2	3
		mm	10	15	20	25	32	40	50	65	80
L	End to end		43	48	53	62	69	75	86	105	116
H	Height		86	96	111	122	141	164	197	225	261
D	Handwheel diam.		50	55	60	70	80	90	100	115	135

**Screwed bonnet, rising stem, Solid wedge disc, Integral seat,**

1.38 MPa (200 psi) W.O.G. non-shock  
 0.86 MPa (125 psi) S.P. saturated

**Fig. 125M**

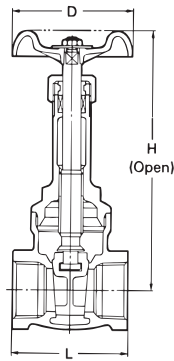

**Test pressure:**  
 Shell 2.07 MPa (300 psi) (Hydrostatic)  
 Seat 1.38 MPa (200 psi) (Hydrostatic)  
 Seat 0.55 MPa (80 psi) (Air)

**Materials**

Parts	Material
Body	Bronze
Bonnet	Bronze
Stem	Bronze
Disc	Bronze
Packing nut	Brass
Gland	Brass rod
Gland packing	Aramid fiber PTFE
Handwheel	Die-cast zinc (1/2"~1") Die-cast aluminum (1 1/4"~3")

**Dimensions**

Valve size	inch	1/2	3/4	1	1 1/4	1 1/2	2	2 1/2	3	mm
	mm	15	20	25	32	40	50	65	80	
<b>L</b> Threaded end to end		51	56	66	68	74	84	115	130	
<b>L1</b> Solder end to end		49	64	76	82	86	109	-	-	
<b>H</b> Height, valve open		129	155	180	216	257	296	371	432	
<b>D</b> Handwheel diam.		55	60	70	80	90	100	135	155	
<b>G</b>		12.7	19.1	23.1	24.6	27.7	34	-	-	